



# Connection Collaboration Celebration

61st Annual Convention March 20 – 21, 2025 Delta Hotels, Winnipeg



MANITOBA  
**School Boards**  
ASSOCIATION

## Program Overview

*Some times may be approximate and are subject to change, with notice.*

### Thursday, March 20

7:30 a.m. - 8:30 a.m.	Registration and Breakfast
8:30 a.m. - 9:00 a.m.	Call to Order - Land Acknowledgment/ Moment of Silence - Welcome - O' Canada (Issac Brock School) - Final Call for Nominations
9:15 a.m. - 10:15 a.m.	Keynote Address— <a href="#">Cassie Campbell-Pascall</a>
10:15 a.m. - 10:30 a.m.	Health Break
10:30 a.m. - 11:45 a.m.	Concurrent Workshops A
11:45 a.m. - 1:00 p.m.	Lunch
1:00 p.m. - 2:15 p.m.	Concurrent Workshops B
2:15 p.m. - 3:15 p.m.	Round Table Discussions
3:15 p.m. - 3:45 p.m.	Health Break
3:45 p.m. - 4:45 p.m.	French Teacher Recruitment and Retention - Bureau de l'éducation française (BEF)
4:00 p.m. - 5:00 p.m.	Board Chairs Meeting with the Honourable Tracy Schmidt, Minister of Education and Early Childhood Learning
5:15 p.m. - 5:55 p.m.	President's Reception
5:30 p.m.	President's Banquet Opens
6:00 p.m.	Drumming-in Entrance of VIP's
6:10 p.m.	President's Welcome
6:20 p.m.	Shared Reflection—Penny Helgason
6:30 p.m.	Meal Service
7:15 p.m.	Awards and Recognition Presentation: - Trustee Long Service Awards - Retiring Executive
8:00 - 10:00 p.m.	Entertainment—Big City All Star Band

### Friday, March 21

7:30 a.m. - 8:30 a.m.	Registration and Breakfast
8:00 a.m.	Scrutineers/Parliamentarian Meeting
8:30 a.m. - 8:45 a.m.	Call to Order - Land Acknowledgment - O' Canada (Maples Collegiate)
8:45 a.m. - 8:55 a.m.	President's Address—Sandy Nemeth
8:55 a.m. - 9:05 a.m.	CSBA President's Address—Alan Campbell
9:05 a.m. - 9:15 a.m.	MSBA Executive Director's Remarks—Josh Watt
9:15 a.m. - 9:30 a.m.	Welcome from the Commissioner of Teacher Professional Conduct—Bobbi Taillefer
9:30 a.m. - 10:00 a.m.	MSBA Executive Elections
10:00 a.m. - 10:30 a.m.	Resolutions Process and Procedure Introduction
10:30 a.m. - 10:45 a.m.	Health Break
10:45 a.m. - 11:00 a.m.	MSBA Executive Elections Results
11:00 a.m. - 12:00 noon	Regional Meetings and Director Elections
12:00 noon	Lunch - Executive Meeting
1:00 p.m. - 2:15 p.m.	Resolutions
2:15 p.m. - 2:30 p.m.	Health Break
2:30 p.m. - 4:00 p.m.	Resolutions
4:00 p.m. - 4:15 p.m.	Closing and Adjournment



*All funds raised stay in Manitoba.*

### Supporting a Good Cause!

**CancerCare Manitoba Foundation** will be the recipient of monies raised by our very popular raffle. Thank you to our member boards for their generous support of this endeavour.

conference hashtag: #mbsba2025

*For more details about important dates, sessions, speakers, resolutions and elections, and to register for the event, follow the convention links at [mbschoolboards.ca](https://mbschoolboards.ca)*



## **Cassie Campbell-Pascall – 9:15 a.m. - 10:15 a.m.**

Cassie Campbell-Pascall is one of the greatest hockey players in Canadian history. During her 16-year career, she rewrote history and created a pathway for women in sport.

A career started with two unsuccessful attempts at being selected to join Team Canada in 1990 and 1992, Cassie fought through adversity to earn her way on the team in 1994. She went on to become one of Canada's most decorated hockey players of all-time, winning three gold medals and capturing eight World Championships.

Following retirement, Cassie joined Hockey Night in Canada's broadcast team and was quickly called up to become the first woman to do colour commentary on Hockey Night in Canada. Covering commentary for three Olympic Games, Cassie is currently an analyst for ESPN and a Special Advisor for the PWHL.

Her breakaway into sport media & creating opportunities to advance the women's game is the next phase for the trailblazer to stamp her legacy in hockey.

## **Workshop Schedule and Descriptions**

**10:45 a.m. - 11:45 a.m., Concurrent Workshops A**

**1:00 p.m. - 2:15 p.m., Concurrent Workshops B**

[Click to view RBC Convention Centre Map](#)

**Morning workshops  
(Concurrent  
Workshops A)  
will be repeated  
in the afternoon  
as (Concurrent  
Workshops B)**



**Kathleen  
Lane**

**A1/B1** — The role of trustees in fostering safe and healthy work and learning environments. Presenter: Kathleen Lane  
Location: Room 2E, RBC Convention Centre

"Education liberates the intellect, unlocks the imagination and is fundamental for self-respect. It is the key to prosperity and opens a world of opportunities, making it possible for each of us to contribute to a progressive, healthy society." ~ United Nations

Across the country education leaders are realizing that fostering wellbeing in our schools and school systems is the key to unlocking the transformational power of public education. Students learn best when they are well. When staff are well, they can do their best work. While the benefits are clear, the path towards fostering wellbeing in K-12 education is complex. In this interactive session, we will:

- Examine pan-Canadian trends that are affecting the wellbeing of students and staff in our school divisions,
- Explore the connections between student and staff wellbeing, and consider how these relate to the goals of our education system,
- Appreciate how actions to create healthier work environments can help attract and retain staff,
- Identify actions that school board trustees can take to foster healthier work and learning environments within their school division and across the province.

**Presenter Bio:** Kathleen is the Executive Director for the EdCan Network, where she previously served as the Program Director for Well at Work. As the Executive Director Kathleen provides strategic leadership to the organization, leading the program management and partnership development. She is particularly interested in creating ecosystems where people can flourish and the role of K-12 education in creating a better future for all.

Kathleen studied population health before earning her Master of Business Administration from the University of British Columbia. She managed two cross-campus research projects to understand how the learning environment affects student mental health and wellbeing. Focused on bridging the theory-to-practice gap, Kathleen presented findings from her research into teaching practices that support student learning and wellbeing at the International Conference for Health Promoting Universities and Colleges and developed instructor resources to support implementation of instructional practices that promote student wellbeing. Over the past several years her work has focused on building management and leadership capacity to support healthy and productive workplaces.

**A2/B2** — Governance in the Age of AI, Presenter: Kirsten Thompson  
Location: Room 2F, RBC Convention Centre

Artificial intelligence (AI) is transforming education, presenting new opportunities and challenges for school governance. This workshop provides an essential introduction to AI, demystifying how it works and exploring its implications for Manitoba's education system. Participants will review current guidance on AI use in Manitoba, examine critical privacy and security considerations, and discuss how AI concerns intersect with existing board policies and procedures. Emphasizing the importance of flexible, principles-based guidelines over rigid procedures, this session equips school board members with the knowledge to navigate AI's integration responsibly and effectively in their communities.

**Presenter Bio:** Kirsten serves as the divisional Coordinator of ICT for the Mountain View School Division; overseeing technology programming and purchasing for approximately 3000 stakeholders. She is a Microsoft Education Trainer as well as a Level 1 Google Certified Educator with over 250 hours of combined professional development on how to assist educators in the use of these tools. Prior to this, she was employed as a classroom teacher in the Turtle River School Division for 6 years where she taught a variety of subjects ranging from Grade 7-12. Kirsten has completed all the required course work as she works towards a Ph.D in the area of educational software evaluation. This work was started at the University of Regina under the supervision of Dr. Alec Couros.

**A3/B3** — Climate Leadership in Manitoba School Boards  
Presenters: Heather Eckton and Will Burton  
Location: Room 2G, RBC Convention Centre

This engaging and impactful workshop will explore essential strategies and insights to empower Manitoba School Boards to lead in climate action. Participants will gain valuable knowledge and practical tools to foster sustainability and environmental leadership within their schools.

Topics of Discussion:

- Key Insights on Climate Change Education: A deep dive into essential takeaways from the latest research on excellence in climate change education, helping school boards understand the most effective ways to engage students and staff.
- The Importance of Climate Leadership and Climate Action Plans: An exploration of why climate leadership is crucial for Manitoba School Boards, along with actionable strategies to implement climate action plans that make a difference at the local level.
- Growing the Good: Climate Action in K-12 Schools: A discussion on how schools can actively contribute to climate change education, with a focus on fostering an ethic of care and a culture of stewardship, amplifying student voices, and promoting collaborative community action to turn these efforts into lasting, hopeful change.



Heather Eckton



Will Burton

**Presenter Bios:**

**Heather Eckton** has devoted over twenty years to public education and is an advocate for amplifying student voices. Currently, she serves as the Climate Action Divisional Teacher Team Leader in Seven Oaks School Division, supporting climate action across 28 K-12 schools. Heather is also an active member of Educators for Climate Action (eca) Manitoba, the UNESCO Associated Schools Project Network in Manitoba, and the founder of the Sustainable Living Academy Manitoba (SLAM). She is a SSHRC Doctoral Fellow at the University of Manitoba, where her research focuses on excellence in climate change education and transformational learning.

**Will Burton** is a lecturer in social and environmental methods courses for pre-service and in-service teachers in the Faculty of Education at the University of Winnipeg. He has a decade of experience in the Manitoba K-12 public education system including at the elementary and senior years, in traditional and alternative learning environments, as both a classroom teacher and principal-teacher. Will's current interest and scholarship focuses on place-based pedagogies, climate change education, and interdisciplinary approaches to the K-12 curriculum. Enrolled at Lakehead University's Ph.D in Educational Studies program, under the guidance of Dr. Ellen Field, his dissertation focuses on the design and facilitation of place-based pedagogies in the K-12 Manitoba education system.

## **A4/B4** — Building Capacity for our Future

Presenters: Jodie Taylor and Josh Watt

Location: Room 2H, RBC Convention Centre

Succession planning helps to ensure that boards are prepared for board members to come and go from the board. Even outside of an election year, boards can do much to promote their work with members of the community. The more people see and understand the board's role in providing for the educational needs of the community's school-aged children, the more likely they will be to put themselves forward for election. To help boards achieve that goal, the association launched a mentorship program (BC4F) in 2022 to recruit and support a more diverse array of candidates to run as candidates in school board elections held that year. Picking up on that theme in preparation for the 2026 elections, this session will provide guidance in general recruitment practices, involving your community, building relationships and running targeted campaigns. Join us to get a head start on developing strategies to promote recruitment and succession planning to keep our school boards strong!

### Presenter Bios:

**Jodie Taylor** is the acting Director, Governance and PD Services at MSBA. To this role she brings a wealth of leadership, policy and governance experience from over 18 years within the field of Human Resources. As someone who believes in growth and opportunities, Jodie has worked in various roles and industries always focusing on developing others as well as herself. She has developed and lead numerous workshops, training sessions, mentorships and events helping others to expand their skills and networks.

Across a quarter century career in politics and policy at all levels of government, **Josh Watt** has served as Executive Director of MSBA for nearly a decade. Having attended Carleton, Manitoba, Winnipeg and Harvard Universities, he is also a current Member of the Royal Canadian Legion, Vice-Chair of the Accessibility Advisory Council of Manitoba and the Alliance Française du Manitoba, and a public interest representative on the Continuing Competency Committee of the College of Registered Nurses of Manitoba. In 2021, he was named a Fellow of the Royal Society of Arts.



Jodie Taylor



Josh Watt

## **Round Table Discussions 2:15 p.m. - 3:15 p.m.**

### Location, Room 2E RBC Convention Centre

- Borderland
- DSFM (region 2)
- Prairie Rose
- Hanover
- Seine River,
- Seven Oaks
- Beautiful Plains
- Swan Valley
- Park West
- Kelsey

### Location, Room 2F RBC Convention Centre

- Red River Valley
- Pine Creek
- Lord Selkirk
- Evergreen
- St. James
- Pembina Trails
- DSFM (region 5)
- Mountain View
- Rolling River
- Frontier

### Location, Room 2G RBC Convention Centre

- Garden Valley
- Prairie Spirit
- Sunrise
- Interlake
- Louis Riel
- Fort La Bosse
- Brandon
- Turtle Mountain
- Flin Flon

### Location, Room 2H RBC Convention Centre

- Portage La Prairie
- Western, DSFM (Region 3)
- Lakeshore
- Whiteshell
- River East Transcona
- Turtle River
- Southwest Horizon
- Mystery Lake
- Winnipeg

[Click to view RBC Convention Centre Map](#)

# RBC Convention Centre Map

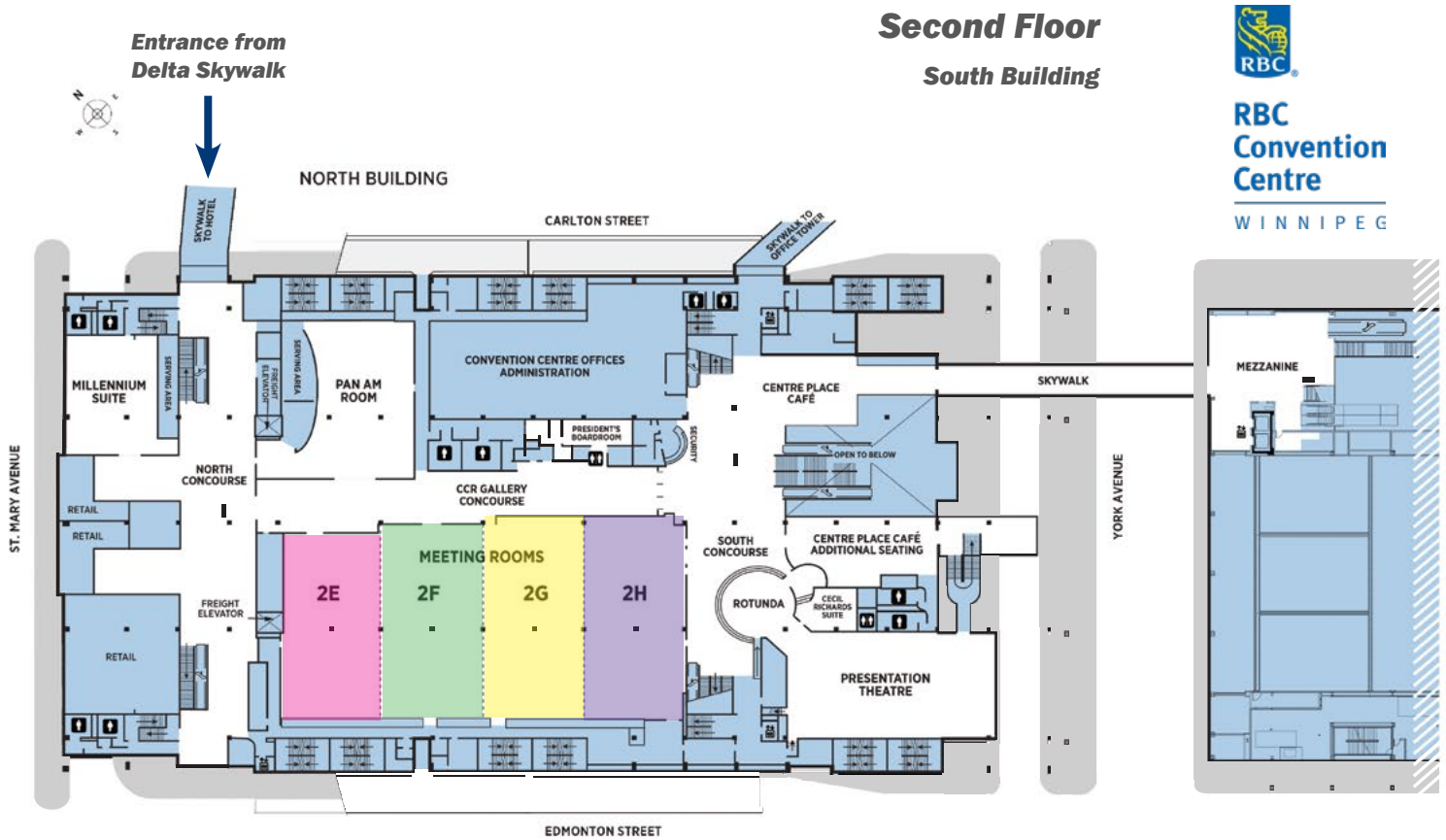

## 10:45 a.m. - 11:45 a.m., Concurrent Workshops A 1:00 p.m. - 2:15 p.m., Concurrent Workshops B

**Location: Room 2E**  
A1/B1— The role of trustees in fostering safe and healthy work and learning environments. Presenter: Kathleen Lane

**Location: Room 2F**  
A2/B2—Governance in the Age of AI, Presenter: Kirsten Thompson

**Location: Room 2G**  
A3/B3—Climate Leadership in Manitoba School Boards  
Presenters: Heather Eckton and Will Burton

**Location: Room 2H**  
A4—Building Capacity for our Future. Presenters: Jodie Taylor and Josh Watt

## 2:15 - 3:15 Round Table Discussions

**Location: Room 2E: Borderland, DSFM (region 2), Prairie Rose, Hanover, Seine River, Seven Oaks, Beautiful Plains, Swan Valley, Park West, Kelsey**

**Location: Room 2F: Red River Valley, Pine Creek, Lord Selkirk, Evergreen, St. James, Pembina Trails, DSFM (region 5), Mountain View, Rolling River, Frontier**

**Location: Room 2G: Garden Valley, Prairie Spirit Sunrise, Interlake, Louis Riel, Fort La Bosse, Brandon, Turtle Mountain, Flin Flon**

**Location: Room 2H: Portage La Prairie, Western, DSFM (Region 3), Lakeshore, Whiteshell, River East, Turtle River, Southwest Horizon, Mystery Lake, Winnipeg**



**61st Annual Convention**

# Thank You to our Event Sponsors!

The Manitoba School Boards Association appreciates the support shown by the sponsors of our Convention.

## Principal Sponsors



## Major Sponsor



## Supporting Sponsors



## Contributing Sponsors



## Custom Sponsors



Breakfast Sponsor

Morning Session Sponsor

Online Registration Sponsor

***This year, the President's Banquet program includes great food and great music, along with the recognition of Long Serving Trustees and Retiring Executive.***



## **Big City All Star Band**

*The Big City All Star Band was formed as a select group of the city's best talent, and have quickly become the area's busiest entertainers. Playing nationally and internationally, this band has a reputation of always delivering a fun energetic show and we're excited to have them with us for this year's entertainment!*

### **Retiring Executive**

**Charlene Gulak, Mountain View SD**  
Director, Region 1 (2022-2024)

**Angela Dunn, St. James-Assiniboia SD**  
Director, Region 5 (2023-2024)

### **2025 Long Service Recipients**

#### **12 Years of Service**

Diedrich Toews, Pine Creek SD  
Allan Downey, Southwest Horizon SD

#### **30 Years of Service**

Linda Ross, Brandon SD



### **Past Presidents**

A.C. Hamilton  
R. Parkinson  
Dr. G.H. Lowther  
B.E. Glavin  
D.K. Compton  
W. Norrie  
W.W. Robson  
J.C. Stangl  
D.D. Durston

M. Hemphill  
K. Burgess  
M. Trott  
E. Hart  
A. Rouse  
J. Murray  
M. Zimmerman  
B. Rose  
G. Marshall

J. Johnson  
L. McIntosh  
D. Mosset  
J. Silver  
V. Kulyk  
B. Leslie  
B. Gladstone  
E. Jonasson  
L. Bergstresser

G. Watson  
M. Van Osch  
C. Duhamel  
B. Green  
R. Schellenberg  
L. Schieman  
D. McGiffin  
R. Toews  
D. Dunnigan

L. Archer  
G. Draper  
R.A. Furgala  
Y. Dupuis  
H. Coburn  
R. Rivard  
F. Martens  
K. Cameron  
A.M. Campbell

### **Convention Planning Committee:**

Penny Helgason, Evergreen SD  
Fred Kelesnik, Red River Valley SD  
Theresa Bergson, Seine River SD—Chair  
Jack Bogaski, Lord Selkirk, SD  
Leah Klassen, VP (< than 6000)  
Heather Poirier, Red River Valley SD  
Jodie Taylor, MSBA Staff

### **Resolutions and Policy Committee:**

Alan Campbell, Interlake SD  
Floyd Martens, Mountain View SD  
Robert Rivard, Seine River SD  
Jack Bogaski, Lord Selkirk SD  
Henk Warner-Brown, SD of Mystery Lake  
Josh Watt, MSBA Staff

### **Nominating Committee:**

Floyd Martens, Mountain View SD  
Robert Rivard, Seine River SD  
Yolande Dupuis, DSFM

Evaluate the convention online at: [surveyMonkey.com/r/LKQMLPK](https://surveyMonkey.com/r/LKQMLPK)

